

# K28

Horsepower: 5  
 RPM: 1300  
 CFM Displ: 21.5  
 CFM DEL: 16.0  
 NO.CYL.: 2  
 Stage: 2

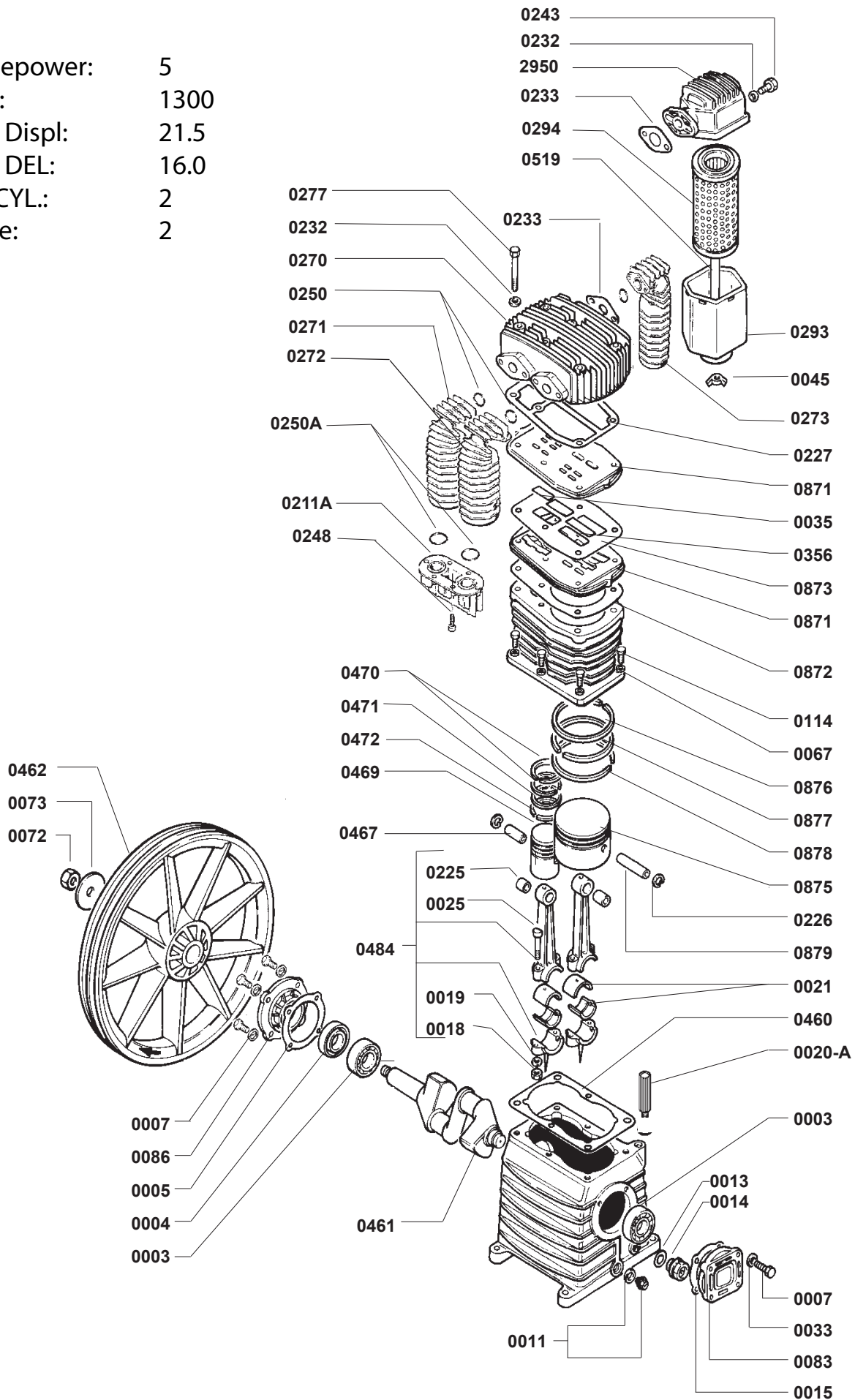

# K28 PUMP

<i>Part Number</i>	<i>Description</i>	<i>Part Number</i>	<i>Description</i>
0003	Ball Bearing	0250	O-Ring
0004	Seal	0250A	O-Ring
0005	Gasket	0253	Screw, Head Cooler
0006	Support	0270	Cylinder Head
0007	Screw; 8 x 12	0271	Left Cooler
0011	Oil Drain Plug	0272	Right Cooler
0013	Gasket, Oil Level	0273	After Cooler
0014	Oil Level Sight Glass	0277	Screw Head (New Style)
0015	Gasket; Front Plate Support	0293	Filter Casing (K30-HU)
0016A	Gasket; Oil Breather (New)	0294	Filter Cartridge
0018	Nut; Connecting Rod	0295	Filter Cover (K30-HU)
0019	Washer; Connecting Rod	0356	Valve Strip
0020A	Oil Breather (New)	0460	Crankcase
0021	Bearing Shell (Pair)	0461	Crankshaft
0025	Bolt; Connecting Rod	0462	Flywheel (2 Groove Aluminum)
0033	Aluminum Washer	0463	Gasket (Crankcase)
0035	Valve Strip	0467	Piston Pin
0045	Wing Nut	0469	Piston D50
0067	Aluminum Washer	0470	Ring, Compression D50
0072	Nut; Flywheel	0471	Ring, Stepped Scraper D50
0073	Washer; Flywheel	0472	Ring, Slotted Oil Scraper D50
0083	Support; Front Plate	0484	Connecting Rod w/Upper Bushing
0086	Support	0519	Tension Rod
0114	Screw, Crankcase Cylinder	0871	Plate, Valve
0211	Connector	0872	Gasket
0225	Bushing D18	0873	Gasket
0226	Circle Clip D18	0874	Cylinder
0227	Gasket, Head	0875	Piston D95
0232	Washer, Head	0876	Ring, Compression
0233	Gasket, Cooler	0877	Ring, Stepped Scraper
0243	Screw, Curved Head	0878	Ring, Slotted Oil Scraper
0271+2A	Inner Cooler Assembly	0879	K28 Piston Pin
0248	Screw, Cooler		