

K25

HP: 3 - 5
 RPM: 800 - 900
 CFM Displ.: 11.7 17.9
 CFM Del.: 8.8 - 13.1
 Cyl: 2
 Stage: 2

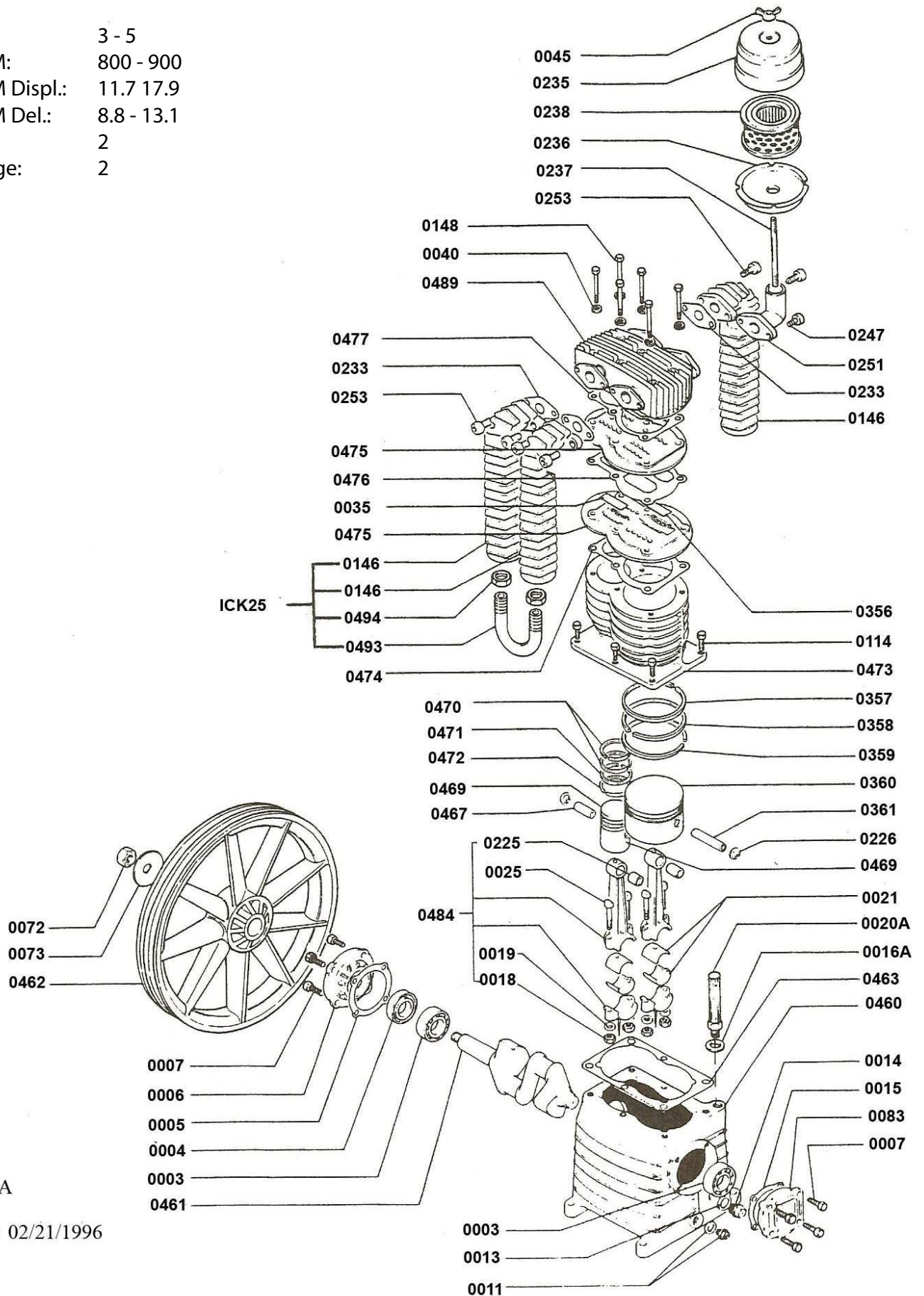

Rev: A

Date: 02/21/1996

K25 PUMP

<i>Part Number</i>	<i>description</i>	<i>Part Number</i>	<i>Description</i>
0003	Ball Bearing	0237	Tension Rod; Filter Assy
0004	Seal	0238	Filter Element
0005	Gasket	0247	Bolt; Filter Assy
0006	Support	0251	Elbow
0007	Screw; 8 x 12	0253	Bolt; Aftercooler/Head
0011	Oil Drain Plug	0356	Valve Strip
0013	Gasket, Oil Level	0357	Ring; LP Compression D90
0014	Oil Level Sight Glass	0358	Ring; LP Stepped Scraper D90
0015	Gasket; Front Plate Support	0359	Ring; LP Slotted Oil Scraper D90
0016A	Gasket; Oil Breather (New)	0360	Piston; Low Pressure, AL D90
0018	Nut; Connecting Rod	0361	Piston Pin, Low Pressure
0019	Washer; Connecting Rod	0460	Crankcase
0020A	Oil Breather (New)	0461	Crankshaft
0021	Bearing Shell (Pair)	0462	Flywheel; 2 Groove Aluminum
0025	Bolt; Connecting Rod	0463	Gasket; Crankcase
0035	Valve Strip	0467	Piston Pin; High Pressure
0040	Washer; Head	0469	Piston; High Pressure D50
0045	Wing Nut	0470	Ring; HP Compression D50
0072	Nut; Flywheel	0471	Ring; Stepped Scraper D50
0073	Washer; Flywheel	0472	Ring; Slotted Oil Scraper D50
0083	Support; Front Plate	0473	Cylinder
0114	Bolt; Crankcase/Cylinder	0474	Gasket; Cylinder/Valve Plate
0146	Aftercooler	0475	Valve Plate; K25
0148	Bolt; Head	0476	Gasket; Valve Plate
0225	Bushing; Connecting Rod	0477	Gasket; Head
0226	Circle Clip	0484	Connecting Rod w/ Upper Bushing
0233	Gasket; Aftercooler	0489	Head
0235	Filter Cover	0493	Connector 1-2
0236	Filter; Base	0494	Nut; Connector/Aftercooler
ICK25	Intercooler Assy.; Includes: 2 - 0146, 1 - 0493, 2 - 0494		

REV: A

DATE: 2/21/96

K25 PARTS VIEW/LISTING