

# K18

Horsepower: 2 - 5  
RPM: 1075  
CFM Displ: 14.3  
CFM DEL: 10.7  
NO. CYL.: 2  
Stage: 1

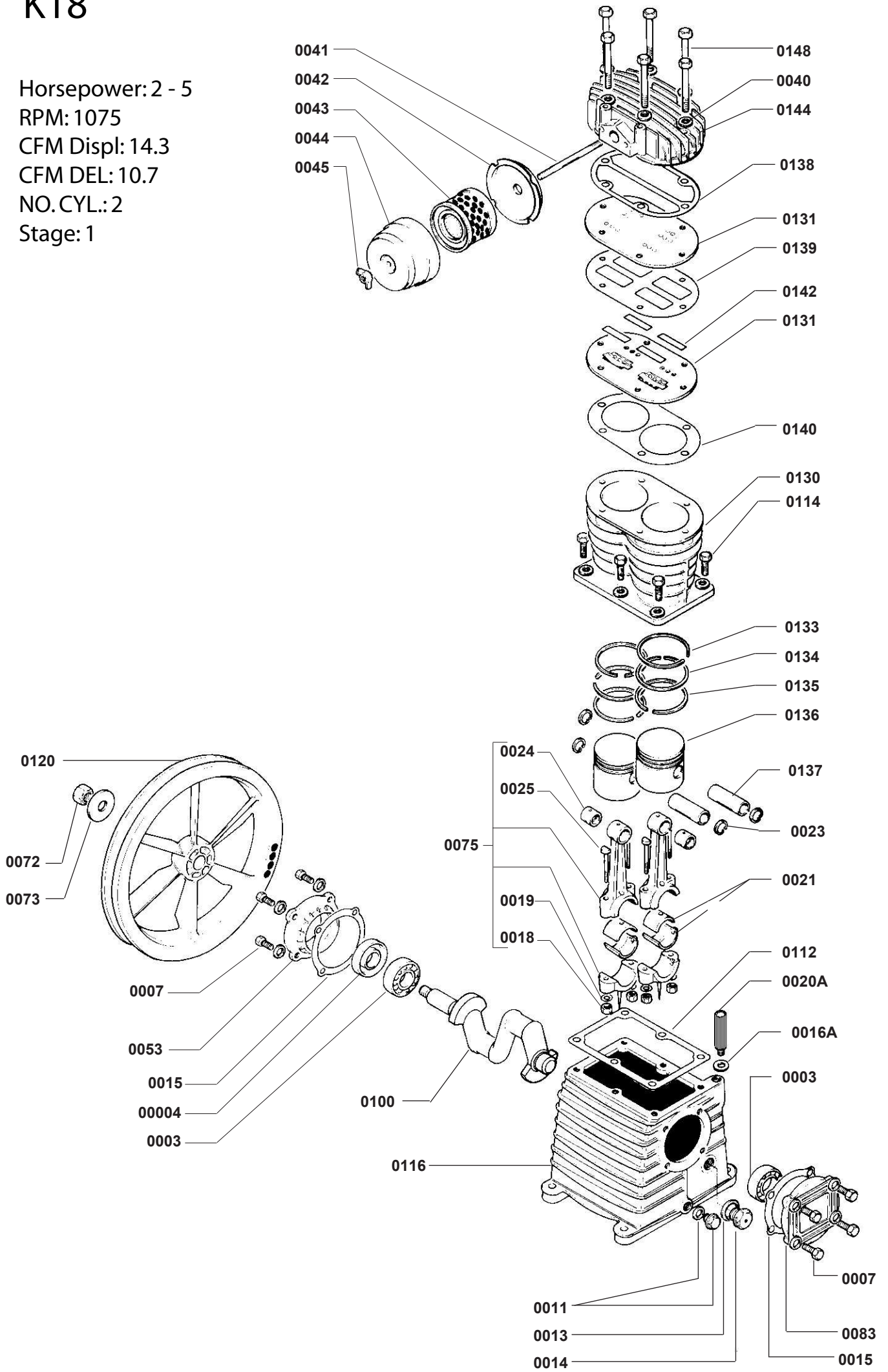

# K17 PUMP

<i>Part Number</i>	<i>description</i>	<i>Part Number</i>	<i>Description</i>
0003	Ball Bearing	0120	Flywheel, 1 Groove Cast Iron
0004	Seal	0130	Cylinder
0007	Screw 8x22	0131	Valve Plate
0011	Oil Drain Plug	0133	Compression Ring D70
0013	Gasket (Oil Level)	0134	Stepped Scrapper Ring D70
0014	Oil Level Sight Gauge	0135	Slotted Oil Scraper Ring D70
0015	Gasket	0136	Piston AL D70
0016A	Gasket (New Style Oil Breather)	0137	Piston Pin
0018	Nut (Connecting Rod)	0138	Gasket (Head)
0019	Washer (Connecting Rod)	0139	Gasket (Valve Plate)
0020A	Oil Breather (New Style)	0140	Gasket (Cylinder-Valve Plate)
0021	Bearing Shell (Pair)	0141	Tension Rod
0023	Circle Clip D15	0142	Valve Strip
0024	Bushing D15	0144	Cylinder Head
0025	Connecting Rod Screw	0148	Screw
0040	Washer (Head)		
0041	Tension Rod		
0042	Filter Cover (Base)		
0043	Filter Element (1 Stage)		
0044	Filter Cover		
0045	Wing Nut		
0053	Support		
0072	Nut Flywheel		
0073	Washer (Flywheel)		
0075	Connecting Rod W/Upper Bushing		
0083	Support		
0100	Crankshaft		
0112	Gasket (Crankcase)		
0114	Screw (Crankcase Sylinder)		
0116	Crankcase (K17-K18)		

REV: A

DATE: 2/21/96

K17 PARTS VIEW/LISTING