

# K17

Horsepower: 3 - 5  
CFM Displ: 10.2 - 12.0  
CFM DEL: 7.1 - 9.5  
NO. CYL.: 2  
Stage: 1

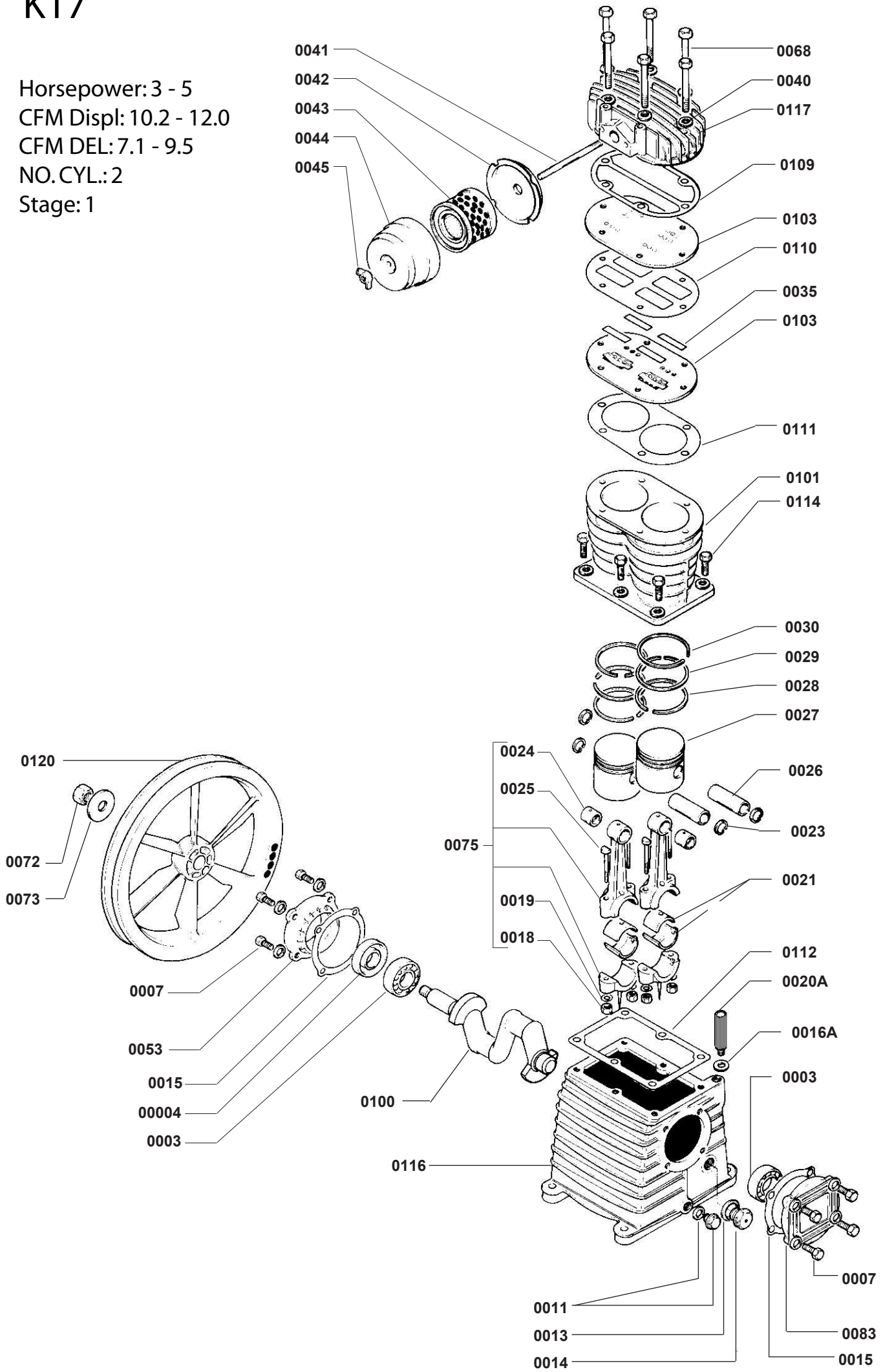

# K17 PUMP

<i>Part Number</i>	<i>description</i>	<i>Part Number</i>	<i>Description</i>
0003	Ball Bearing	0073	Washer (Flywheel)
0004	Seal	0075	Connecting Rod W/Upper Bushing
0007	Screw 8x22	0083	Support
0011	Oil Drain Plug	0100	Crankshaft
0013	Gasket (Oil Level)	0101	Cylinder
0014	Oil Level Sight Gauge	0103	Valve Plate
0015	Gasket	0109	Gasket (Head)
0016A	Gasket (New Style Oil Breather)	0110	Gasket (Valve Plate)
0018	Nut (Connecting Rod)	0111	Gasket (Cylinder-Valve Plate)
0019	Washer (Connecting Rod)	0112	Gasket (Crankcase)
0020A	Oil Breather (New Style)	0114	Screw (Crankcase Sylinder)
0021	Bearing Shell (Pair)	0116	Crankcase (K17-K18)
0023	Circle Clip D15	0117	Cylinder Head
0024	Bushing D15	0120	Flywheel (1 Groove Cast Iron)
0025	Connecting Rod Screw		
0026	Piston Pin		
0027	Piston AL D64		
0028	Slotted Oil Scraped Ring D64		
0029	Stepped Scraper Ring D64		
0030	Compression Ring D64		
0035	Valve Strip		
0040	Washer (Head)		
0041	Tension Rod		
0042	Filter Cover (Base)		
0043	Filter Element (1 Stage)		
0044	Filter Cover		
0045	Wing Nut		
0053	Support		
0068	Screw (Head)		
0072	Nut Flywheel		

REV: A

DATE: 2/21/96

K17 PARTS VIEW/LISTING